

Explore the property...

EPC & Floor Plans

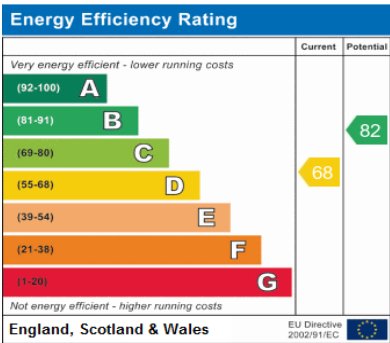

GROUND FLOOR

1ST FLOOR

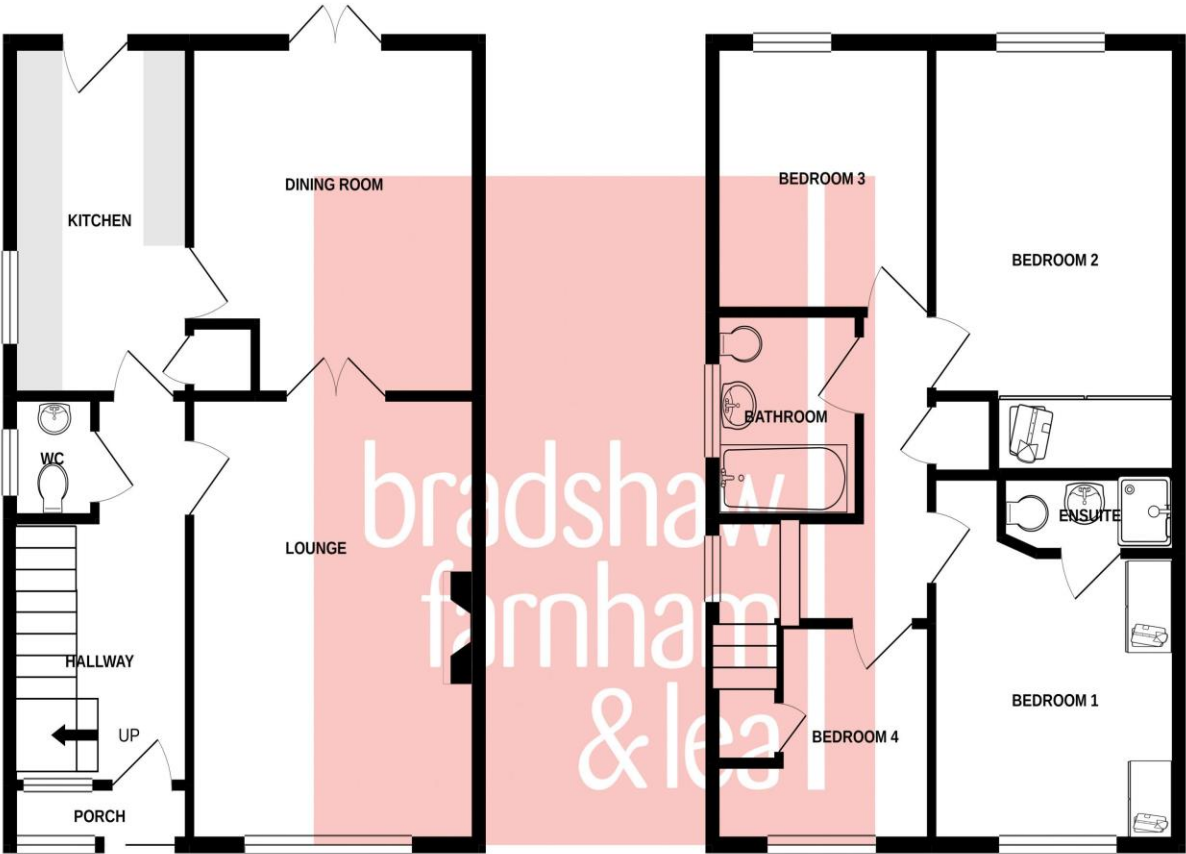

Whilst every attempt has been made to ensure the accuracy of the floorplan contained here, measurements of doors, windows, rooms and any other items are approximate and no responsibility is taken for any error, omission or mis-statement. This plan is for illustrative purposes only and should be used as such by any prospective purchaser. The services, systems and appliances shown have not been tested and no guarantee as to their operability or efficiency can be given.  
Made with Metropix ©2021

Tenure: Freehold

The Small Print...

Agents Note: These particulars are thought to be correct, though their accuracy cannot be guaranteed and they do not form part of any contract. Please note that we have not tested any apparatus, fixtures, fittings or services and as such cannot verify that they are in working order or fit for their purpose. Furthermore, solicitors should confirm that moveable items described in the sales particulars are, in fact, included in the sale since circumstances do change during marketing or negotiations. A final inspection prior to exchange of contracts is also recommended. Although we try to ensure accuracy, measurements used in this brochure may be approximate. Therefore, if intending purchasers need accurate measurements to order carpeting, or to ensure existing furniture will fit, they should take such measurements themselves.

Contact Bradshaw Farnham & Lea - West Kirby  
Call - 0151 625 8844  
Email - westkirby@bflhomes.co.uk  
Visit - 18 The Crescent West Kirby

rightmove



11 Foxwood Close  
CH48 9YE

Offers in Excess of £295,000

bradshaw  
farnham  
& lea



To arrange a  
viewing call us on  
0151 625 8844

- Detached family home
- Four bedrooms
- Well presented

- Spacious sunny garden
- Garage and Driveway
- Virtual Tour Available

www.bflhomes.com



About the property...

\*\*\*DETACHED\*\*\* FOUR BEDROOMS\*\*\*  
ENSUITE\*\*\* REAR GARDEN\*\*\* GREAT FAMILY  
HOME\*\*\*VIRTUAL TOUR AVAILABLE\*\*\* An  
immaculate, well presented home set within  
a pleasant and popular residential location,  
within a 'no through road' position, this four  
bedroom detached home offers tastefully  
presented accommodation and must be  
viewed within to appreciate. The driveway  
approach offers off road parking for multiple  
cars with the interior comprising of hallway,  
spacious lounge with feature fireplace, dining  
room, fitted kitchen with integral appliances,  
four bedrooms, the master benefitting from  
an ensuite shower room and a family  
bathroom. To the external there is a superb  
south west facing rear aspect making this a  
delightful garden throughout the summer  
months with the parking and garage  
completing the accommodation. The property  
also benefits from Solar Panels which is a truly  
renewable energy source... Must be viewed  
to fully appreciate.

About the location...

From the West Kirby sales office, proceed up  
Grange Hill and at the top turn left down  
Blackhorse Hill. Continue along Frankby Road  
to the mini roundabout and turn left into  
China Farm Lane. Take the second left into  
Grange Farm Crescent and first left into  
Fairfield Drive. Foxfield Close is the first road  
on the right.

